



# THE PANTHEON

SPACIOUS 2 BHK HOMES

VIJAY NAGAR COLONY

SADASHIV PETH, PUNE

# STEP INTO THE BRIGHT LIFE



Nestled in the heart of Sadashiv Peth, The Pantheon  
by Unitee Realtors offers limited-edition homes that  
blend luxury, comfort, and holistic living.

With exceptional design and a prime location,  
it's where elegance meets convenience.











### SITE ADDRESS

2085, Vijaynagar Colony, Sadashiv Peth, Pune 411030



# LIVE WHERE THE CITY MEETS YOU



Surrounded by renowned schools, top-tier hospitals, vibrant shopping hubs, and serene gardens, every essential is just a step away. Experience the joy of living in a neighbourhood that keeps you connected to everything you need while offering a peaceful retreat in the bustling city.

## CLOSE TO YOU

- |                              |                                |
|------------------------------|--------------------------------|
| ◆ Tilak Road- 2 mins away    | ◆ Tilak Smarak- 3 mins away    |
| ◆ Bajirao Road- 2 mins away  | ◆ Deccan Chowk- 10 mins away   |
| ◆ S. P. College- 2 mins away | ◆ Nal Stop Chowk- 15 mins away |







**ELEGANCE**  
*Meets* **COMFORT**

**THE PANTHEON**





## TYPICAL FLOOR PLAN

2nd to 7th FLOOR

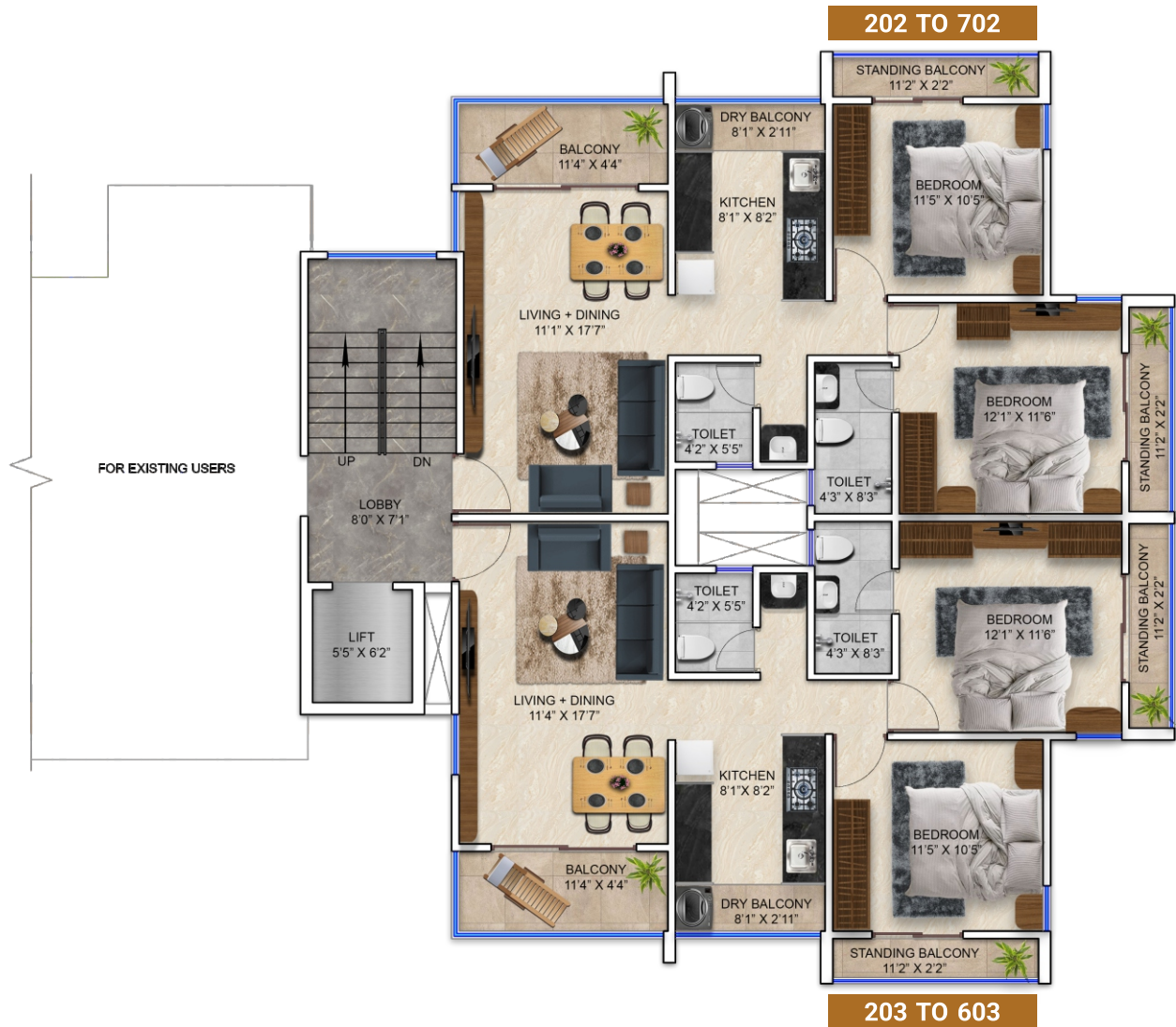

### SPACIOUS 2BHK APARTMENTS

| FLAT NO    | CARPET AREA OF FLAT (SQ.M.) | BALCONY AREA (SQ.M.) | TOTAL RERA CARPET AREA (SQ.M.) |
|------------|-----------------------------|----------------------|--------------------------------|
| 202 TO 702 | 63.15                       | 5.18                 | 68.33                          |
| 203 TO 603 | 63.15                       | 5.18                 | 68.33                          |

# SPECIFICATIONS



## Structure:

- Earthquake-resistant R.C.C. frame with anti-termite treatment.
- 100% waterproofing for terrace and toilets.



## Masonry:

- 5" AAC blocks for external and internal walls.



## Plastering:

- Double coat sand-faced external plaster with chicken mesh.
- POP/Gypsum finish for smooth interiors.



## Flooring:

- 5'x2.5' vitrified tiles with matching skirting.



## Doors:

- Main door: Veneer finish.
- Internal doors: Waterproof flush with SS fittings & locks (Godrej/Europa).



## Windows:

- Powder-coated 3-track aluminum sliding windows with mosquito nets.
- M.S. designer grills; adjustable louvered panels for toilets.



**Toilets:**

- Solar water heating, non-skid flooring, designer tiles.
- Concealed plumbing with Jaguar/equivalent C.P. fittings, wall-hung commodes, and Hindware equivalent basins.

**Electrification:**

- Concealed copper wiring with Roma/M.K. switches/ Legrand or equivalent
- Separate meters for flats and common areas.

**Painting:**

- Emulsion for interiors; antifungal acrylic for exteriors.

**Water Supply:**

- Ground and overhead tanks with automatic controllers with 2 pump arrangement.

**Power Backup:**

- For lift, parking, staircase, and water pumps.



# SALIENT FEATURES



Decorative entrance lobby



Well planned parking area with  
paving blocks and adequate lighting



IGBC Gold rated project



Electronic security system with  
video door phone



Solar water heater system



6/8 passenger auto-door elevator  
of reputed make



Toilet for watchman/Drivers/  
Servants at Parking Level.



CCTV Surveillance





**STANDING BALCONY**  
11'2" x 22"

BALCONY 11'4" x 6'0"

LIVING & DINING 11'0" x 17'0"

KITCHEN 8'4" x 9'0"

BEDROOM 11'0" x 10'0"

BEDROOM 12'7" x 11'0"

BATH 5'0" x 6'0"

TERRACE 10'0" x 17'0"

STAIRS

**STANDING BALCONY**  
22" x 11'2"

[illegible]

## KEY PLAN





A PROJECT BY

**UNITEE**  
REALTORS LLP



SCAN FOR  
SITE LOCATION

Office Address :  
35, Laxmi Park,  
Navi Peth, Pune 30

FOR ENQUIRY

**98810 95499 | 70304 90555**